

REV. NO.	REVISION NOTE	REVISER	DATE
V0	NEW DRAWING		2023/02/22

**Technical Specs:**

Insulator: Black glass filled polyester PA46-GF30-FR
 Flammability: UL 94V-0
 Sleeve: Brass CuZn36Pb3 (C36000)
 Contact clip (6 finger): Beryllium copper (C17200)
 Mating pins: Outside Diameter 0.38 to 0.50 mm
 Forces: (polished steel gauge Outside Diameter 0.41 mm)
 Insertion: 0.5 N typ.
 Withdrawal: 0.2 N typ.
 Mechanical life: min 500 cycles
 Rated current: 1 A
 Contact resistance: max 20 Milliohms
 Dielectric strength: min 500 V RMS
 Coplanarity SMDterminations: max 0.1 mm
 (measured on 25 mm long connectors)

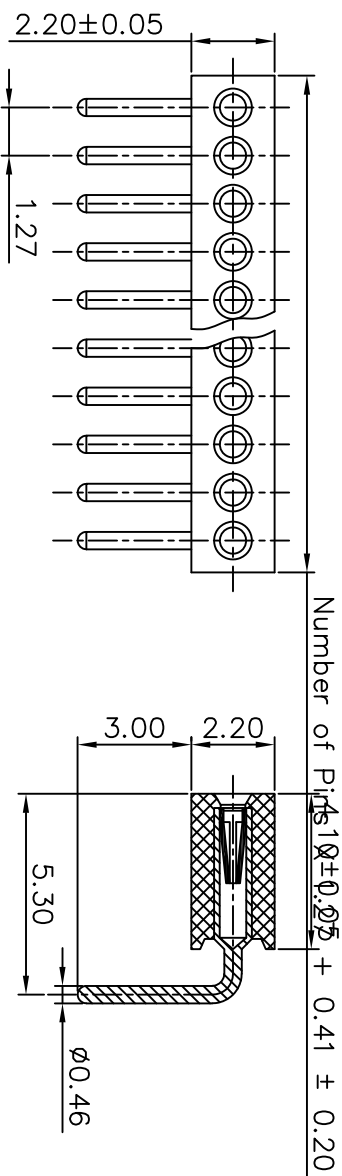

Recommended P.C.Board Layout

Http://www.ciscomn.com				深圳市新世联电子有限公司 TEL:+86(755)29912370 FAX:29912372	
Tolerance Unless Otherwise Specified		Title		1.27MM圆PIN排母 RA	
.X ~ ±0.30	⊕	Units	Scale	REV NO.	Material No.
.XX ~ ±0.25	⊖	mm	2:1	V0	
.XXX ~ ±0.20	∠	Date	Reviewed By	Date	Approval By
Angle ~ ± 3°		2023/02/22			